

FC38-30490-C36
SHT 1.1

NOTES:

- 1. INCREASED PRESSURE AT THE SOUND INLET CAUSES A POSITIVE GOING VOLTAGE TO APPEAR AT THE OUTPUT TERMINAL, RELATIVE TO THE NEGATIVE TERMINAL.

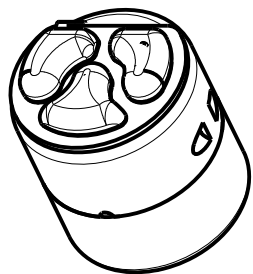
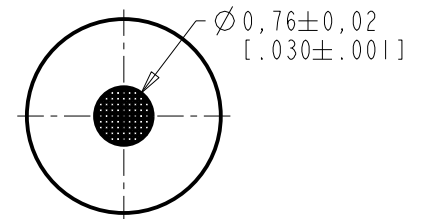
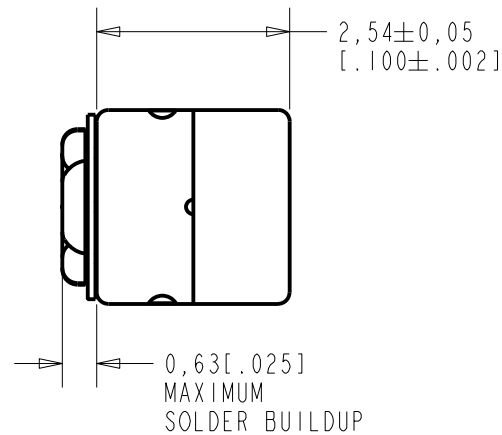
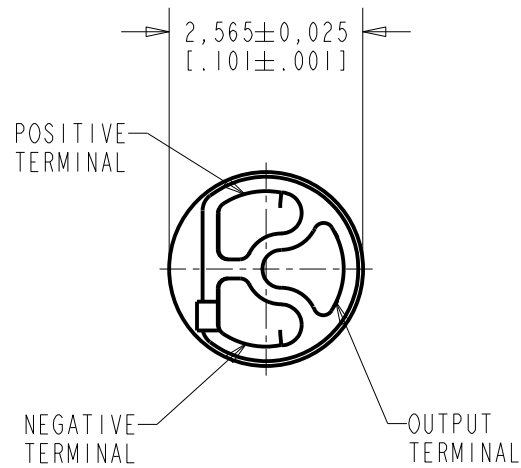

DIMENSIONS IN MILLIMETERS [INCHES]

KNOWLES ELECTRONICS
ITASCA, ILLINOIS U.S.A.

Revision	C.O. #	Implementation Date	RELEASE LEVEL	REVISION
F	MI0105709	10-23-14	Active	F
E	MI0104555	4-26-12		
D	MI0104117	5-20-11		

SCALE: 10:1		DR. BY: SJ	DATE: 12-23-08
DO NOT SCALE DRAWING			
TITLE: MICROPHONE		FC38-30490-C36	
OUTLINE DRAWING		SHT 1.1	
		CK. BY: GJP	DATE: 1-4-09
		APP. BY: GJP	DATE: 1-4-09

RoHS COMPLIANT

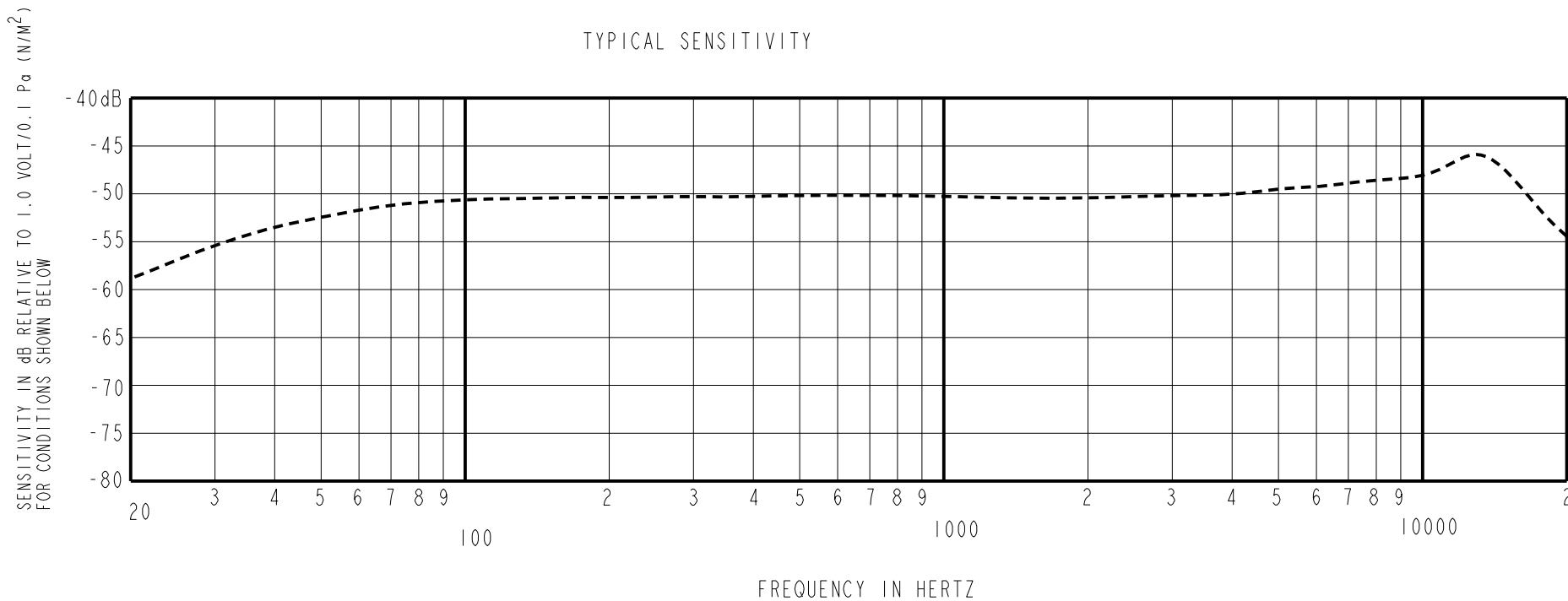

SENSITIVITY MEASURED IN A PRESSURE CAVITY UNDER THE NOMINAL CONDITIONS SHOWN BELOW

POWER REQUIREMENT					
PARAMETER	UNIT	MINIMUM	NOMINAL	MAXIMUM	REMARKS
DC POWER SUPPLY	VDC	0.9	1.3	1.6	-

PERFORMANCE							
PARAMETERS		UNIT	MINIMUM	NOMINAL	MAXIMUM	REMARKS	
SENSITIVITY	100 Hz	dB	-2.0	-0.6	0.0	re SENSITIVITY AT 1 kHz	
	1000 Hz	dB	-54.0	-51.0	-48.0	dB re 1V/0.1Pa	
	10000 Hz	dB	1.0	2.5	6.0	re SENSITIVITY AT 1 kHz	
SENSITIVITY CHANGE ON REDUCING SUPPLY TO 0.9 VDC		1000 Hz	dB	-3.0	0.0	3.0	REDUCED FROM 1.3 VDC TO 0.9 VDC
AMPLIFIER CURRENT DRAIN		μA	-	26.5	30	-	
OUTPUT LOAD VOLTAGE		V _L	0.20	0.45	0.90	OPEN LOAD	
A-WEIGHTED NOISE		dB(A)	-	25.0	28.0	INPUT REFERRED NOISE, dB(A) SPL, re SENSITIVITY AT 1kHz	
OUTPUT IMPEDANCE		Ohms	2750	4400	6750		

- NOTES: 1. CASE CONNECTED TO NEGATIVE TERMINAL.
2. SENSITIVITY AND NOISE VALUES INDICATED ON THIS SPECIFICATION ARE VALID AT 1.3 VDC AND 909KOhm//<1500pF LOAD IMPEDANCE TYPICAL TEST ENVIRONMENT: 50% RH, 21°C(70°F)

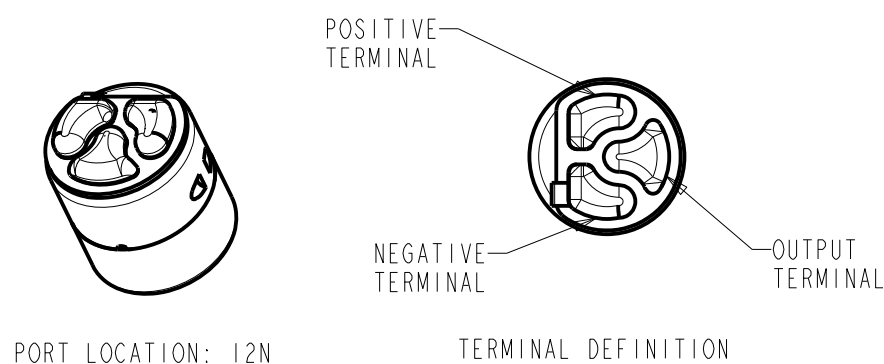

KNOWLES RESERVES THE RIGHT TO MAKE CHANGES TO IMPROVE RELIABILITY AND PERFORMANCE OF THE PRODUCT

Revision	C.O. #	Implementation Date	RELEASE LEVEL	REVISION
F	M10105709	10-23-14	Active	F
E	M10104555	4-26-12		
D	M10104117	5-20-11		

KNOWLES ELECTRONICS
ITASCA, ILLINOIS U.S.A.

WHEN TEST LIMITS ARE USED TO ESTABLISH INCOMING INSPECTION ACCEPTANCE/REJECTION CRITERIA, CORRELATION OF TEST EQUIPMENT WITH KNOWLES IS ALSO REQUIRED FOR ELIMINATION OF EQUIPMENT AND TEST METHOD VARIATION

TITLE:	MICROPHONE	FG38-30490-C36
	PERFORMANCE SPECIFICATION	SHT 2.1

DR. BY	DATE
SJ	12-23-08
CK. BY	DATE
GJP	1-4-09
APP. BY	DATE
GJP	1-4-09

RoHS COMPLIANT

A) 1/3 OCTAVE INPUT REFERRED NOISE

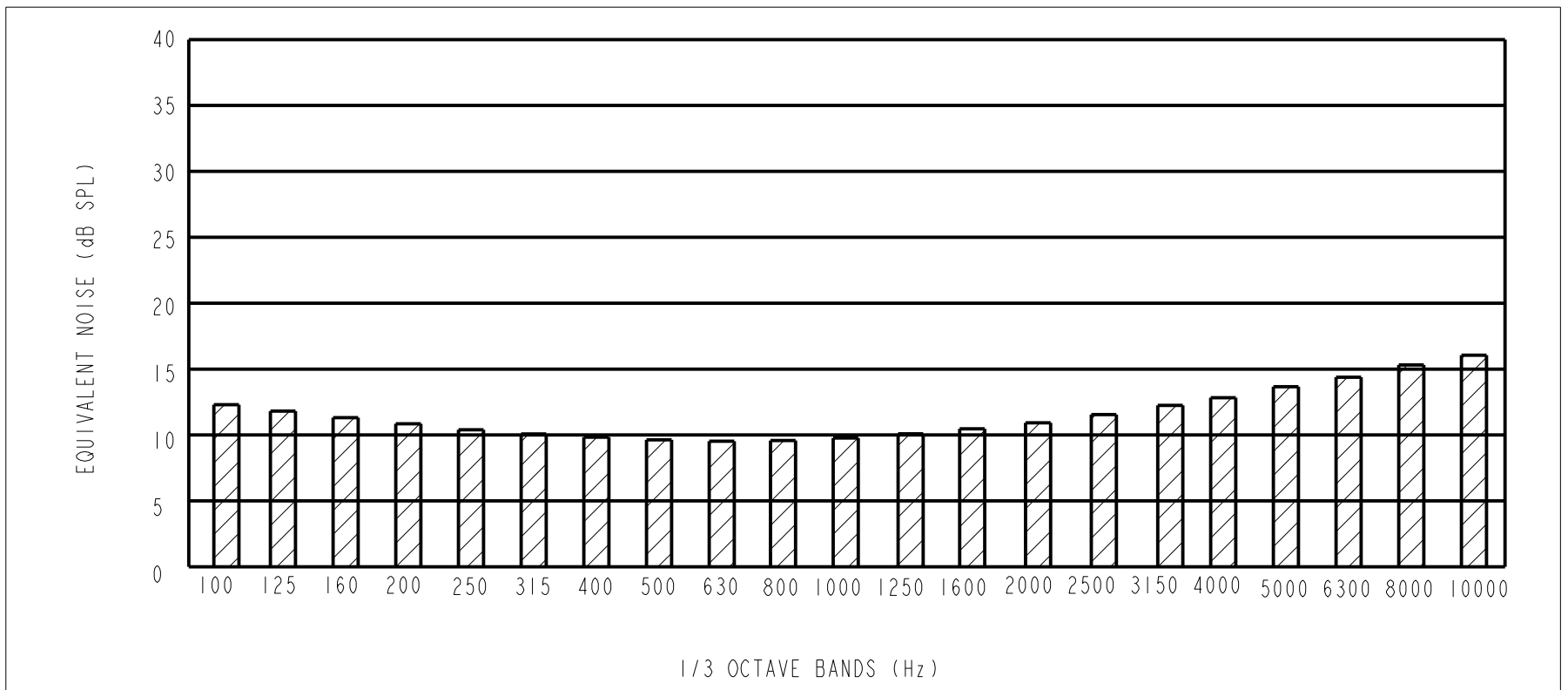

B) PERFORMANCE

PERFORMANCE						
PARAMETERS		UNIT	MINIMUM	NOMINAL	MAXIMUM	REMARKS
POWER SUPPLY REJECTION RATIO (PSRR)	1000 Hz	dB	-	-32	-20	SUPPLY VOLTAGE @ 1.3 VDC
INPUT REFERRED VIBRATION SENSITIVITY	1000 Hz	dB SPL	-	-	57	BLOCKED PORT; 1g ACCELERATION
HUMIDITY COEFFICIENT	1000 Hz	dB		0.06		PER %RH
TEMPERATURE RANGE	OPERATION	°C(°F)	-17(1.4)	-	63(145.4)	CELSIUS(FAHRENHEIT)
	STORAGE	°C(°F)	-40(-40)	-	63(145.4)	CELSIUS(FAHRENHEIT)
ESD TOLERANCE	MIL-STD-750 CLASS 2 RATING EOS/ESD-S5.1-1993 CLASS 2 RATING					

KNOWLES RESERVES THE RIGHT TO MAKE CHANGES TO IMPROVE RELIABILITY AND PERFORMANCE OF THE PRODUCT

Revision	C.O. #	Implementation Date	RELEASE LEVEL	REVISION
F	M10105709	10-23-14	Active	F
E	M10104555	4-26-12		
D	M10104117	5-20-11		

KNOWLES ELECTRONICS
ITASCA, ILLINOIS U.S.A.

WHEN TEST LIMITS ARE USED TO ESTABLISH INCOMING INSPECTION ACCEPTANCE/REJECTION CRITERIA, CORRELATION OF TEST EQUIPMENT WITH KNOWLES IS ALSO REQUIRED FOR ELIMINATION OF EQUIPMENT AND TEST METHOD VARIATION

TITLE: **MICROPHONE** **FG38-30490-C36**
PERFORMANCE SPECIFICATION **SHT 2.2**

DR. BY	DATE
SJ	12-23-08
CK. BY	DATE
GJP	1-4-09
APP. BY	DATE
GJP	1-4-09